

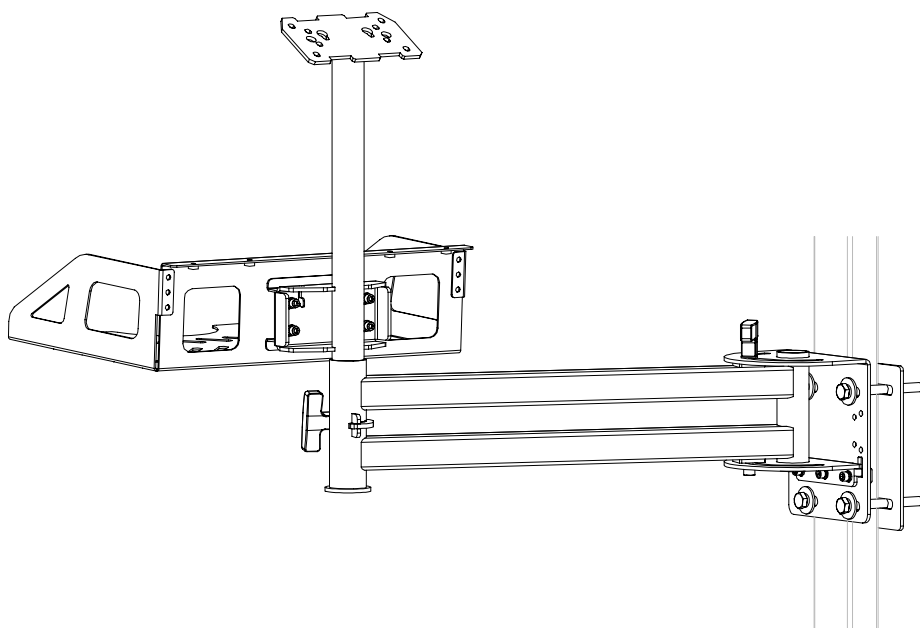

Swivel Arm Installation Instructions

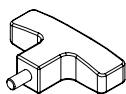



**T-shaped Handle
Screw M6x12**

① 1x

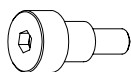

**Shoulder
Screw(Φ8x8xM6)**

② 1x

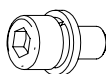

**Combination Screw
M6X12**

③ 11x

(4 of them are used for
LP-V1 or LP-F1 V3.0
installation)

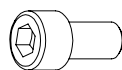

**Screw
M10X20**

④ 2x

(for LP-F1 V2.2
installation)



**Bolt
M10X100**

⑤ 4x



**Large Plain Washer
M6x18**

⑥ 1x



**Large Plain Washer
M8x24**

⑦ 1x



**Plain Washer
M10**

⑧ 2x

(for LP-F1 V2.2
installation)



**Thicker Plain Washer
M10x25x4**

⑨ 8x



**Spring Washer
M10**

⑩ 10x

(2 of them are used for
LP-F1 V2.2 installation)



**Nut
M10**

⑪ 4x



**4mm Allen key
M6**

⑫ 1x



**5mm Allen key
M6**

⑬ 1x



**8mm Allen key
M10**

⑭ 1x



**16mm Open-end
Wrench M10**

⑮ 2x

3

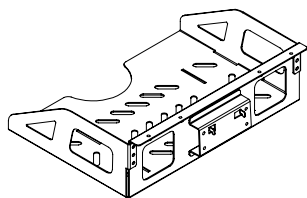

A 1x

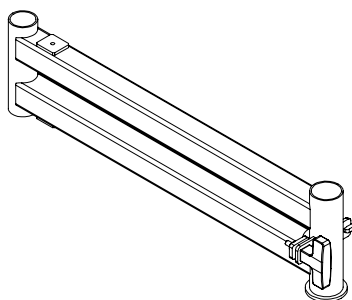

B 1x

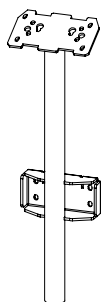

C 1x

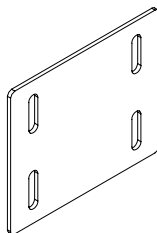

D 1x

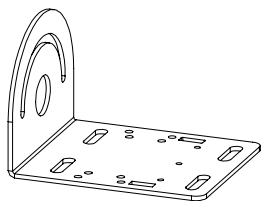

E 1x

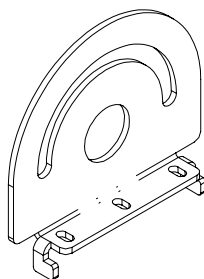

F 1x

4

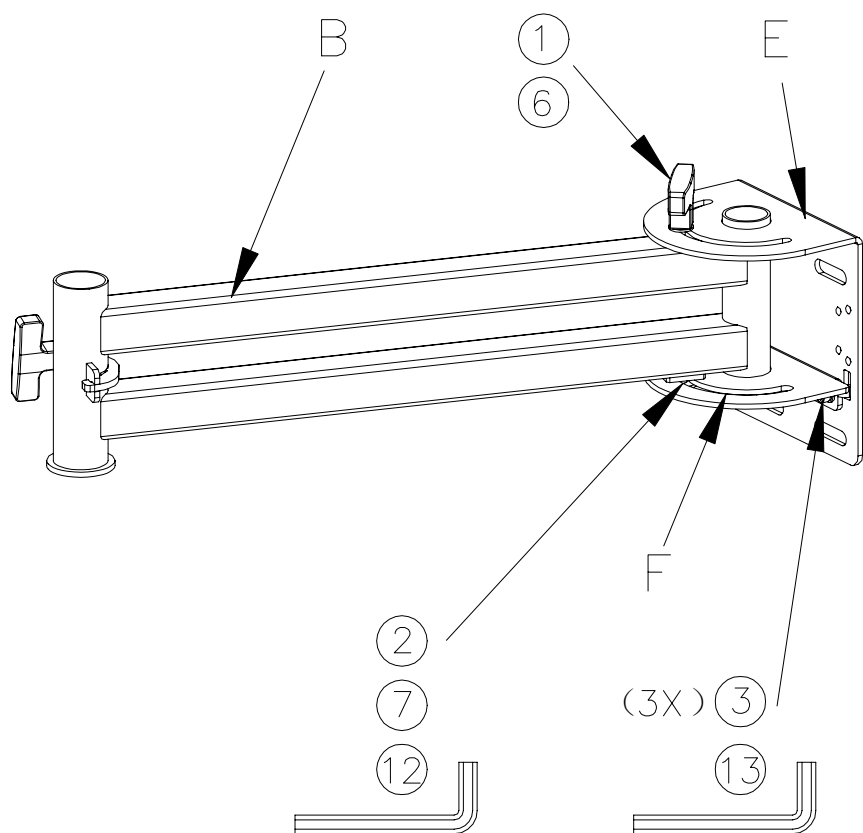

5

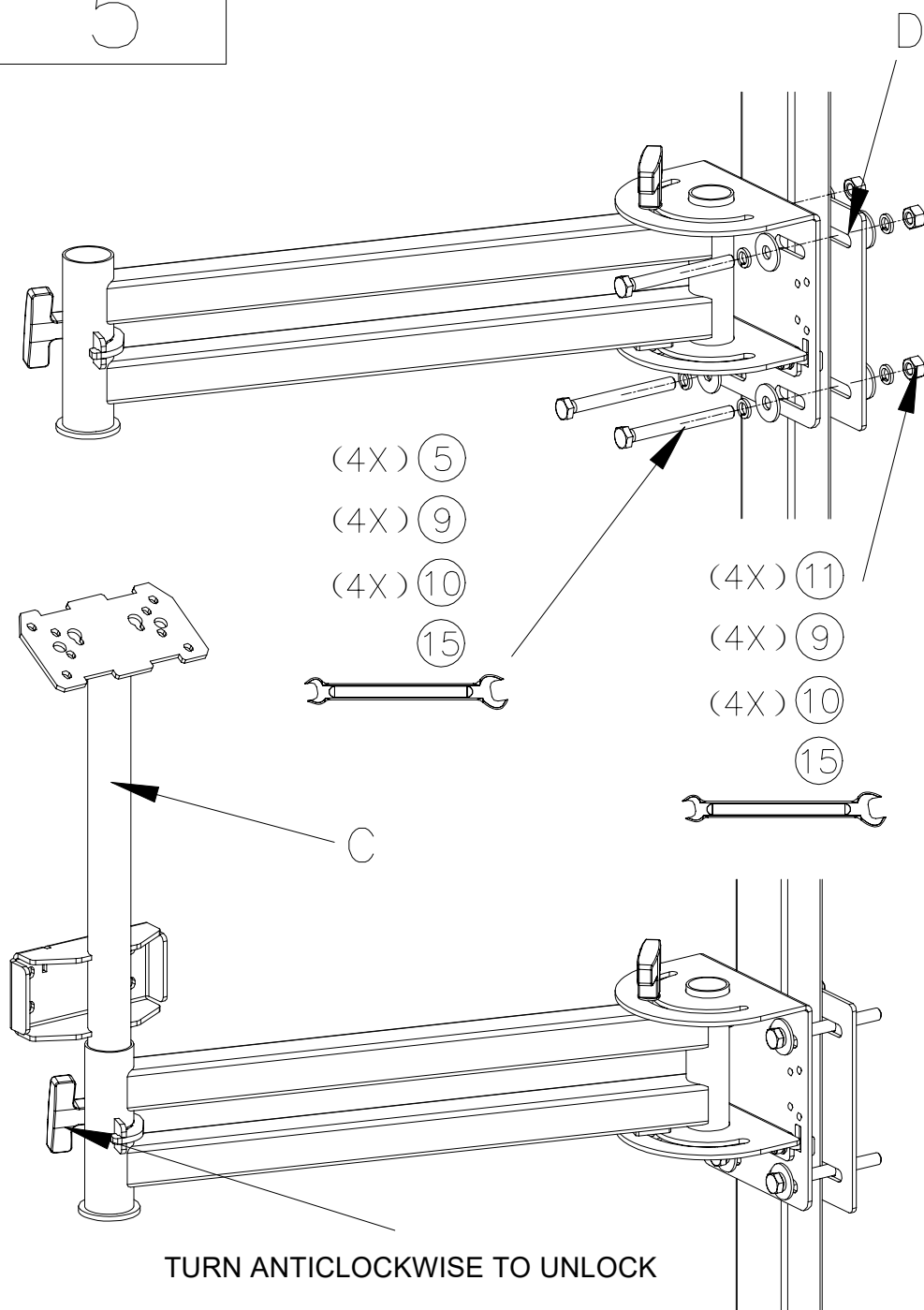

6

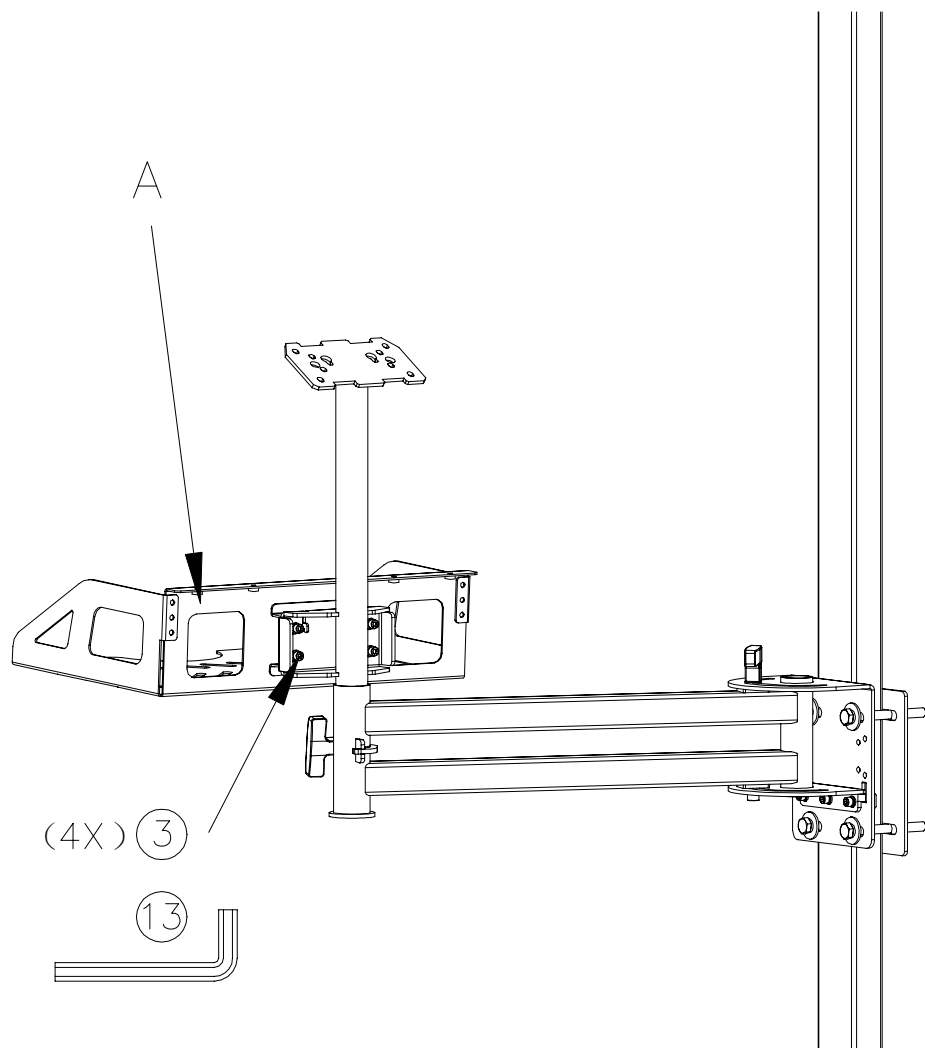

7

For LP-F1 V2.2 Installation

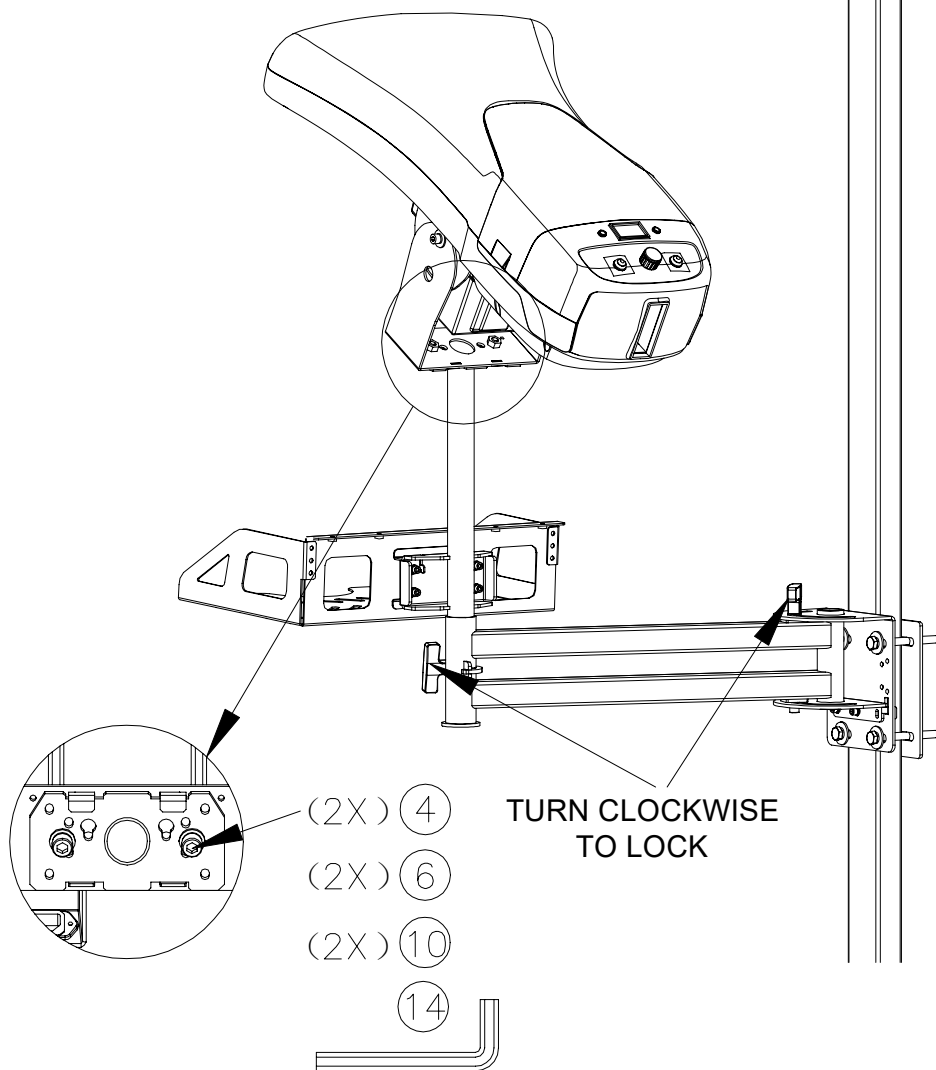

For LP-F1 V3.0 Installation

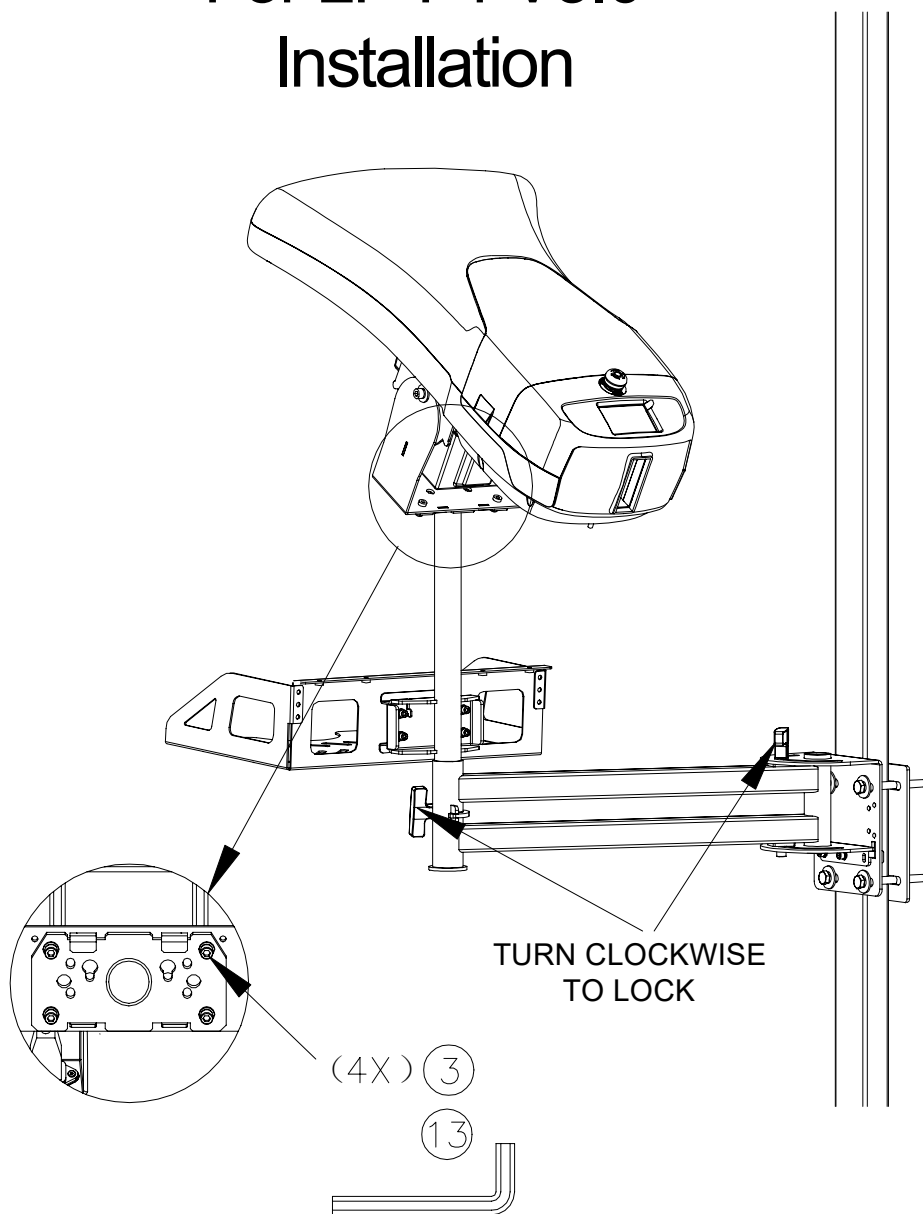

For LP-V1 Installation

